



# Ministry Handbook

## Christ Lutheran Church

4761 Cass Street  
San Diego, CA 92109  
Telephone: (858) 483-2300  
FAX: (858) 483-5777  
Email: [clcsd@christpb.org](mailto:clcsd@christpb.org)

We are dedicated to sharing God's unconditional  
love and to telling the story of Jesus to all



# Table of Contents

Vision	1
Worship Times	2
Welcome Statement	2
Pastors and Staff	2
New Member Process	3
Stewardship	4
Volunteer Ministries	
Worship	5
Music	5-6
Small Groups	6-7
Christian Education	7
Adults	
Youth	
Children	
Women of CLC	7
Caring Ministries	8
Health Ministries	8
Support Ministry	9
Seasonal Service Projects	9
Social Concerns	10
Other Outreach Ministries	10
Open Door Books	11
Church Governance	11
Theological Questions	12-13
A Final Note	14
Map of Church Campus	16

Saints,  
Sinners,  
and Surfers  
Welcome



## Vision

*We are dedicated to experience and share God's unconditional love and to tell the story of Jesus to all.*

## Values of Christ Lutheran Church

***The life and teachings of Jesus,*** his priorities, habits and promises.  
We strive to know and to follow him.

***Worship*** as we come together regularly to praise, thank and petition God through song, prayer and offering, to confess our failures and to receive God's good news of forgiveness, hope and healing.

***Personal Ministry*** as the contribution each person brings to our community through that person's unique gifts and individual calling.

***Balance*** as we seek to provide time and place for all things needful in a rhythm of prayer, study, work and play.

***Excellence*** that honors God and inspires people.

## Worship Celebrations

9:30 a.m.

Sunday morning in the Sanctuary.

Christian Education for all ages at 10:45 a.m.

## Welcoming Statement

“We warmly welcome you to be a member of our church family. You are invited to be a part of our community; regardless of your race, ethnicity, gender, age, sexual orientation, marital status, social or economic state, physical or mental challenge, and whether you are confident or questioning in your faith. We offer opportunities through the week for worship, study, service, and fellowship.

As Lutheran Christians, we are a people centered not in judgment, but in God’s unconditional grace through Jesus Christ. Our tradition is one of ongoing renewal and reform in the church, through the power of the Holy Spirit. We invite you to make Christ Lutheran Church your home and to participate actively in our mission to share God’s unconditional love and tell the story of Jesus to all.”

## Christ Lutheran Church Staff

The People of Christ – Ministers

Rev. Richard Rollefson –Lead Pastor

Rev. Erin Martinson—Pastor of Outreach

Candace Springer – Office Administrator

Teri Forbes—Coordinator of Visitation and Senior Ministry

Janis Peterson – Business Manager

John Jay Owens—Campus Coordinator

# New Mission Partner Process

## Our Vision for Mission...

*We dedicate ourselves to experience and share God's unconditional love and to tell the story of Jesus to all.*

When you join our mission at Christ Church you are affirming your commitment to our vision. This commitment means several things:

- ✠ Wanting to grow in faith and learn more about Jesus so you can follow him, spending time in prayer, reading the Bible.
- ✠ Recognizing the importance of being in community, of sharing other's joys and sorrows, of being part of what the Bible calls "the body of Christ" which is the church, doing Christ's work and telling his story so that others can come to know the love of God.
- ✠ Using the gifts God has given in service to others
- ✠ Worshipping regularly—praising God for God's goodness and gifts, asking for and receiving forgiveness, hearing God's Word, receiving the Sacraments, receiving refreshment and empowerment from the Holy Spirit to live every day with joy and confidence.

## How to Join Our Mission

- ☆ Attend an **Orientation Gathering**, where you will tour Christ Lutheran's campus, hear about the history and current ministry activities, plans for the future, and sign on with our mission team.
- ☆ Affirm your commitment during Sunday morning worship
- ☆ Ongoing learning, fellowship and service as you continue your spiritual journey

For additional information or to sign up for the next class, please contact Patricia Savage, Membership Coordinator (858) 483-2300.

# Stewardship

Part of our commitment as Christians involves giving. In the Old Testament we read about the tithe—giving one tenth of the first fruits of the harvest to God. In the New Testament, the picture of the early church depicts a community who gave, who shared all things in common.

Stewardship is a spiritual discipline, a response to God's call from the very beginning to care for all that God has made.

We are called to continue Christ Lutheran's tradition of stewardship and to discover new ways of caring for the environment, of addressing justice issues connected to global ecological issues and world hunger, and to take our commitment to mission seriously enough to provide the necessary support in both our giving of money and, what has become an even more precious commodity, our time.

In order to keep things running, we do need financial support. Each person in our community is encouraged to fill out a pledge card, in the fall indicating the amount to be given during the year ahead. How much you give is between you and God. We formulate our budget based on last year's expenses and with an eye toward our vision for mission—how much do we need to continue to share God's unconditional love and to tell the story of Jesus to all? We are grateful for the generosity and commitment of many people and look forward to an even greater involvement in financial support and in offering of ourselves—our time and talents—to the mission of our congregation.

If you would like an envelope packet for your giving mailed to you, please contact Janis Peterson, Finance Administrator, (858) 483-2300. Giving by automatic bank withdrawals can be set up, or you may donate stock.

# Volunteer Ministry Programs

As a member of the priesthood of all believers, each of us has gifts that are needed for the mission of the church. Everyone is invited to discover what their gifts are through a Spiritual Gifts Inventory, and are encouraged to serve in whatever way they feel called.

## Worship Ministries

**Worship & Arts**—Help plan our worship and worship environment, if interested in joining this group **contact Pastor Richard, (858) 483-2300.**

**Altar Guild**—Prepares the altar for Holy Communion, keeps altar linens and silver clean, and maintains supply of candles. Training provided. **Contact Church Office, (858) 483-2300.**

**Readers/Lectors**—Serve as readers of Old Testament and Epistle at the worship services. Time commitment one or more Sundays a month, on a rotation through out the year. Children are welcome! **Contact the Church Office, (858) 483-2300.**

**Worship Assistant**—Help lead worship including distribution of communion. training sessions held throughout the year. **Contact the Church Office, (858) 483-2300.**

**Ushers**—Greet worshipers as they arrive for service, distribute bulletins, receive offering on a regular appointed basis. **Contact Church Office, (858) 483-2300.**

**Sound Technicians**—Operate the audio and video equipment during worship Sunday morning, for funerals, or other special occasions or events. **Contact Church Office, (858) 483-2300**

## Music

**Chancel Choir**—Offers music leadership at Sunday worship as well as presents several special musical events throughout the year. Rehearsals are Thursday evening each week at 7:00 p.m. **Contact the Church Office, (858) 483-2300.**

**Special Music Opportunities**—Opportunities for vocal or instrumental soloists, person interested in forming a small ensemble, hand bell ringers, helpers with children's music. **Contact the Church Office, (858) 483-2300.**

## Small Groups

*Where two or three are gathered in my name, I am there among them.*

Matthew 18:20

A Small Group is an intentional, face to face gathering of three to twelve people on a regular time schedule with a common purpose of discovering and growing in the possibilities of the abundant life in Christ. A Small Group is intentional because commitment to the group is a high priority. A Small Group is personal, where sharing experiences and insights is more important than mastering content. A Small Group is conversational, and leaders facilitate conversation rather than teaching. A Small Group is friendly—a warm, accepting, non-judgmental atmosphere is fostered. A Small Group is Christ-centered because the experience is biblically based, related to the real world and founded on Christ.

### Small Groups at Christ

***Tuesday Morning Bible Study***—Meets at 9:30 every Tuesday morning in the Lounge. Join the Pastor for a study of the Bible lessons assigned to the following Sunday.

### Women's Circles

**Martha Circle** meets the first Monday of the month at Christ Lutheran, at 1:30 PM in the lounge. Contact **Jo Ann Longerbone, (858) 274-0483**.

**Mary Circle** meets the first Tuesday of the month at in on of their homes at 7:30 PM. Contact **Millie Mealey, (858) 453-1170**.

**Joanna Circle** meets the first Saturday of the month at 10:00 AM at members' homes. Contact **Jan Stadler, (858) 412-5500**.

**Renovaré**—It is designed to open new paths for Christians toward a deeper relationship with God, and to increase the level of our discipleship. Tuesday Morning Men's Group meets in the Library contact **Dick Turner, (858) 274-3812**.

If you have any questions about Small Groups or suggestions for new Groups, contact the **Pastors (858) 483-2300**.

## Christian Education

### Adults

**Adult Forums**—Sunday morning 10:45 to 11:45 am. Various topics. There are several weekly opportunities for Bible study.

**Tuesday Mornings**—Explore the weekly lessons for the next Sunday worship service every Tuesday at 9:30 a.m. in the Lounge.

### Youth

**Confirmation Education**—7th, and 8th Grade students meet monthly on the first Sunday at noon. This is a combined class with the youth at St. Peters By the Sea Lutheran Church. **Contact Pastor Richard (858) 483-2300.**

**Sunday Morning**—6th-12th grade students meet every Sunday morning at 10:00 a.m. for time of learning about Jesus and God's love. **Contact the Church Office (858)483-2300.**

### Children

**Preschool God's Garden**—Our younger children meet every Sunday at 10:00 a.m. Through music and play, children are introduced to Bible stories that will be the foundation of their future learning about God and his unconditional love for them.

**God's Garden**—Elementary age children (K-5th Grade) meet every Sunday at 10:00 am for time of learning about Jesus and God's love. **Contact the Church Office (858) 483-2300.**

### Women of CLC

Connected to the women's organization of the ELCA and the Pacifica Synod. Circles meet monthly for bible study and fellowship. We gather several times a year for other social and educational events, including Mother/Daughter Luncheon, brunch gathering for women from Lutheran Churches around the San Diego area, and participation in events sponsored by the wider church, including an annual Synodical Convention filled with music and sharing, learning opportunities and inspirational speakers. Contact Jo Ann Longerbone (858) 274-0483.

## Caring Ministries

**Stephen Minister**—Is an exciting lay caring ministry here at Christ Lutheran Church. It is a two year commitment that begins with 50 hours of training to build skills in listening, communicating and caring. Those who receive the Stephen Ministry will be helped personally, as well as equipped to reach out to others who are in need of support and care. **Contact Pastor Richard or Teri Forbes, (858) 483-2300.**

**Transportation**—Provide rides to members in your area for regular Sunday morning worship or for scheduled program events or meetings at the church weekdays. **Contact the Church Office, (858) 483-2300.**

**Intercessory Prayer**—This group lifts up the prayer concerns of those at Christ Lutheran church. As a member of the Prayer Ministry Group you will be asked to commit to pray for these people or concerns each day. You will receive special prayer requests from the church office or the group organizer as specific needs arise. **Contact the Church Office, (858) 483-2300.**

**Prayer Chain**—This is a group of people that share the concerns of those in need of support and care though the gift of prayer. Names are given to a caring Minister to hold before God. If you wish to have the prayer chain started for you or some one in need please call Patricia at the **Church Office, (858) 483-2300**, she will start the prayer chain.

**Prayers & Squares**—This group sews prayer quilts, patches etc. to be distributed to those who need the comfort of extra prayers during a critical or special time in their lives (birth, sickness, death, healing, etc.). Contact Person: **Millie Mealey, (858) 453-1170.**

**Memorial Receptions**—Members provide refreshments or help at the reception following a memorial service. If you can provide refreshments or help contact **Jo Ann Longerbone, (858) 274-0483.**

## Health Ministries

Health Ministries addresses our church community as a place of health and wholeness in body, mind, and spirit. Participation is welcome in the following areas:

**Blood Pressure Screenings**—Blood pressure screening is offered the first Sunday of the month between services. Assistance is needed from medical personnel for this preventative health measure. **Contact Dr. Ron Reinsch.**

**Blood Mobile**—An annual Spring event held in partnership with St. Brigid's Catholic Church, donors are solicited from both church communities. Also, help is requested for set-up, take-down and serving refreshments, and scheduling. **Contact Dr. Ron Reinsch.**

## Support Ministry

**Telephone/Receptionist Relief**—Assist in the church office by answering phones, data entry, making copies, assembling materials and miscellaneous office duties. **Contact Church Office, (858) 483-2300.**

**Mail Crew**—Meets the last Wednesday of the month at 10:00 AM to prepare the “Good News” for mailing. Time commitment is flexible. **Contact Church Office, (858) 483-2300.**

**Liturgy Collators**—Collate the liturgy books used on Sunday morning. Time commitment is each week on Thursday afternoon for 1—1 1/2 hours. **Contact Church Office, (858) 483-2300.**

## Seasonal Service Projects

**Interfaith Shelter Network**—For two weeks each year, Christ Lutheran is host to approximately 12 – 16 homeless persons in transition. Shelter, clothing and meals are provided. Volunteers sign up for a variety of tasks. Time commitments vary from one hour to several depending on personal desire. For time and needs **contact Mary Swenson, (858) 488-7347.**

**Lenten Lunches**—Lenten Services each Wednesday at noon & 7:00 p.m. A soup lunch is provided on Wednesdays following the Lenten service. Volunteers are needed to make the meal, and clean up. To Coordinate or help with the lunch contact the **Church Office, (858) 483-2300.**

**Thanksgiving Dinner**—Prepares and serves Thanksgiving dinner each year for approximately 600 persons from the Pacific Beach Community. Time commitment varies according to job description. If you would like to become involved in the preparation or serving of the dinner, **contact Jackie Hanson, (858) 483-6478 or Bill and Jan Bopp, (858) 272-8986**

**Pajama Project**—Flannel pajamas are sewn to be distributed to children who are in need in San Diego. An organization is chosen to distribute them. Sewing begins in August and pajama are collected by mid December so the pajamas can be distributed for Christmas. For more information **contact CJ McAuliffe, (619) 276-7024 or Jo Ann Longerbone, (858) 274-0483.**

## Social Concerns

**Green Leaf Team (Faith & Environment)**—The Green Leaf team is a group of people focused on how faith values drive us to be good stewards of the earth. The team works on educating Christ Lutheran Church and the local community on how to live “greener”. Sending out weekly tips, hosting Adult Forums, movie nights and advocating for a more environmentally friendly community are just a few of things this team does. If you would like to be involved, share ideas or be encouraged in your earth stewardship please **contact Pastor Erin, (858) 483-2300**.

**Community Christian Service Agency**—CCSA Provides emergency assistance to people in need, as well as assisting people in accessing other community services appropriate to their needs. If you would like to donate food, clothing or your time, or if you are interested in attaining the services provided by the CCSA, contact **Jack Belvins (858) 274-2271**.

**Our Daily Bread**—This is a program that provides lunch to the Hungry and Homeless in our community every Friday at noon. It is hosted at Christ Lutheran Church in Garman Fellowship Hall and prepared and served by Catholic Workers and other Volunteers. For more information contact **Tina Distefano, (858) 552-0817**.

**Next Step Program**—This is a hands up ministry working with the homeless in our neighborhood offering help to those willing to take the next step to a more meaningful life. Contact **Carl Nelson or Church Office, (858) 483-2300**.

## Other Outreach Ministries

*Luther View Apartments (low income senior apartments)*

*Beach Camp (in cooperation with Lutheran Camps & Retreats)*

*AA & NA support groups*

*Open Gym nights*

*Ballroom Dancing*

*Overnight accommodations for mission groups (Mexico and or Habitat)*

*Rancho San Juan Bosco Orphanage, Tecate Mexico*

*El Shaddai Orphanage, Kigali, Rwanda*

*Hispanic Ministry at Clairemont Lutheran (support)*

*SDSU Lutheran Campus Ministries*

*World Hunger*

## Open Door Books

***Managers: Pat Guest, Mary Mueller, Cyndi Rollefson, & Jackie Hanson***

An outreach ministry program dedicated to strengthening the bonds between all people regardless of creed or race. A non-profit ecumenical and interfaith bookstore and strive to reflect the teachings of God and Jesus Christ in all that we do. Volunteers meet and wait on customers, stock shelves and run the cash register. **Open Door Books (858) 270-8642.**

## Church Governance

Christ Lutheran Church is a member church of the Evangelical Lutheran Church in America (ELCA) headquartered in Chicago, Illinois. As a member of the ELCA we have over 10,000 sister congregations in the United States representing approximately 5,000,000 individuals. Mark Hanson is currently serving as Presiding Bishop of the ELCA.

The national church provides guidance and leadership, as does the Pacifica Synod, with offices located in Yorba Linda. The Bishop of the Pacifica Synod is Murray Finck. Most of the decisions pertaining to the mission and operation of Christ Lutheran Church are made here within the leadership of the congregation.

Throughout the 60-year history of Christ Lutheran Church we have been blessed with outstanding leadership. Each year in January, members of the congregation vote to select members of our governing body, the Church Council. Each Council member has, in addition to their corporate decision making responsibilities, a particular area of interest on which they regularly report to the Council. The Church Council for 2008 is:

Stephanie Boomhower, President	JB Morch, Vice President
Tim Rupe, Secretary	Kim Springer, Treasurer
Jan Bopp	John Fray
Bryan Jones	Jean Overstreet
Judith Sedler	Stephen Seper
Kim Springer	

# Some Theological Questions

## **What is a Lutheran?**

Lutheran Christianity is a way of seeing, a way of hearing, a way of teaching, a way of following. We share many characteristics with other Christian traditions, but there are some distinguishing marks of being a Lutheran Christian.

### *A Way of Seeing*

The cross is the central symbol for us because it is on the cross that God meets us, is present with us hidden in weakness, vulnerable, suffering, forsaken, dying. God finds *us* in our own darkness, weakness. We do not find God.

Sacraments represent God's action through physical things—the promise of God connected to the physical element and the human action. Sacraments are the means by which God makes God's love, grace or Gospel (Good News) known to us. We have two sacraments, Baptism and Holy Communion.

Baptism is water used together with God's Word and by God's command as found in Matthew 28, where Jesus says:

*“Go therefore and make disciples of all nations, baptizing them in the name of the Father and the Son and of the Holy Spirit.”*

Baptism incorporates us into Christ and his body, the church, and makes us God's adopted daughters and sons, forgives us our sins, calls us into new life, ordains us to be ministers, marks us with the cross of Christ forever, gives us the gift of the Holy Spirit. We are made right with God solely through God's action and God's love—we can't earn any part of this relationship with God, this new identity.

Holy Communion is the meal we share together every week. Christ is present in the bread and in the wine, as he is in all creation. We remember Christ's death and resurrection, and we join with the living Christ—God with us—in the meal and we are given a “foretaste of the feast to come” when God's Kingdom will come. Also called the Eucharist, which means “thanksgiving” in Greek, or the Lord's Supper.

### *A Way of Hearing*

The **Living Word** follows a Hebrew way of thinking: truth is not a proposition, but is the living, creative, powerful address of a loving God. Being open to understand the Bible in this way brings about what the New Testament called *metanoia*, which means to turn around and go in the opposite direction (conversion). This causes change in the way we live our lives, giving up our games, false gods, illusions, vindication, excuses. The Bible holds the living Christ who, as the Scriptures are read and proclaimed, lives as God's address to us, through the power of the Holy Spirit.

### *A Way of Teaching*

God comes in events rather than in ideas or dogmas. The most important document of the Reformation, the movement that brought about the separation between the Roman Catholic and the “Protestant” churches, was the Augsburg Confession of 1530. It outlined the Lutheran movement, defining it as catholic, evangelical, and reforming.

Catholic, used in this sense, means being part of the universal Christian Church of all time in all places. We pray for and work for the unity of the whole church on earth, when all Christians will be gathered into a single body.

Evangelical means we preach the Good News (evangelical comes from a Greek word that means the public proclamation of good news). The Good News is that we receive forgiveness and are made right with God by grace, through faith, not by any doing of ourselves. It is a free, gratuitous gift from our loving God. “Faith” is not an intellectual assent to doctrine or concepts, but is active trust in God’s unconditional love.

Reforming reflects the purpose of Martin Luther, which was to bring about change in the Roman Church. He defined the church as the assembly of all believers among whom the Gospel is preached in its purity (God’s unconditional love in Christ), and the sacraments are administered according to the Gospel. This means we are (ideally) continually open to the action of the Holy Spirit to bring about change when and where necessary so that we are faithful to the Gospel.

### *A Way of Following*

This can be called the “Theology of the Cross.” It means meeting God in the reality of our lives, our pain, our sorrow and our weakness; hearing God’s word of grace in the death of Jesus on the cross; and following Jesus in his death and resurrection through our Baptism, which is the death of our “turned-in-onself” and our birth living as a new person, daily remembering our baptism, and continually turning to God for forgiveness when we fall short. We are called to live in the radical way Jesus did, following rather than merely admiring him.

## A Final Note

We are excited to be in ministry together in this new millennium in the rapidly changing community of Pacific Beach. We invite you to be part of our ministry team—to actively participate in worship, to learn and grow through prayer and study, and to go and to share God's unconditional love and to tell the story of Jesus to all. We hope you will develop relationships with others in the community, the kind of relationships that mean you both give and receive love and support, sharing in sorrows and in joys alike.

It is a privilege for us to be the pastors in this exciting community of faith. We look forward to getting to know you better, to working together as partners in ministry, sharing God's love.



Luther View North

Luther View South

# CHRIST LUTHERAN CAMPUS



Notes: R = restroom  
Not to scale

CHALCEDONY STREET

TO THE OCEAN



CASS STREET

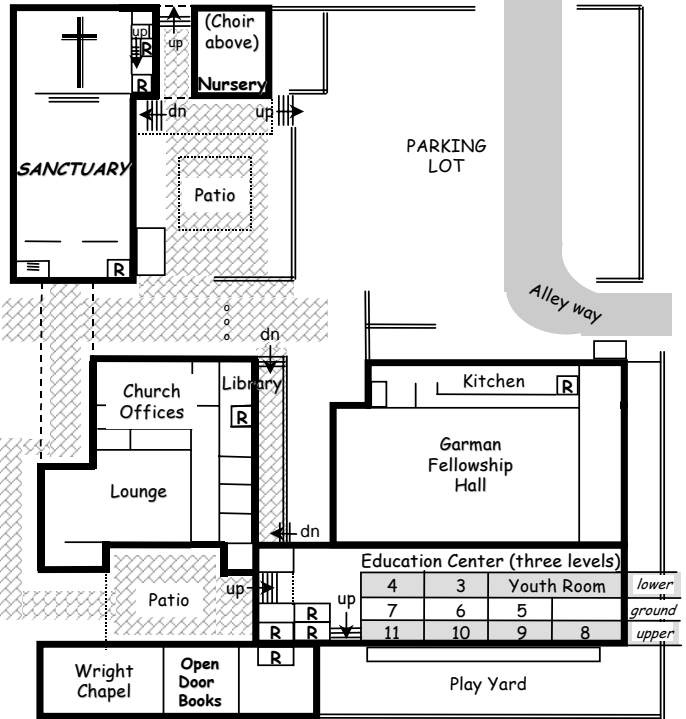

Education Center (three levels)				lower
4	3	Youth Room		ground
7	6	5		
11	10	9	8	upper

MISSOURI STREET

## Christ Lutheran Church

4761 Cass Street

San Diego, CA 92109

Telephone: (858) 483-2300

FAX: (858) 483-5777

Email: [clcsd@christpb.org](mailto:clcsd@christpb.org)

April, 2009